

MONOGLASS SPRAYED THERMAL & ACOUSTIC INSULATION™



MONOGLASS SPRAYED THERMAL & ACOUSTIC INSULATION™



SAVES MONEY,



MONOGLASS SPRAYED THERMAL & ACOUSTIC INSULATION™



**SAVES MONEY,
TIME**

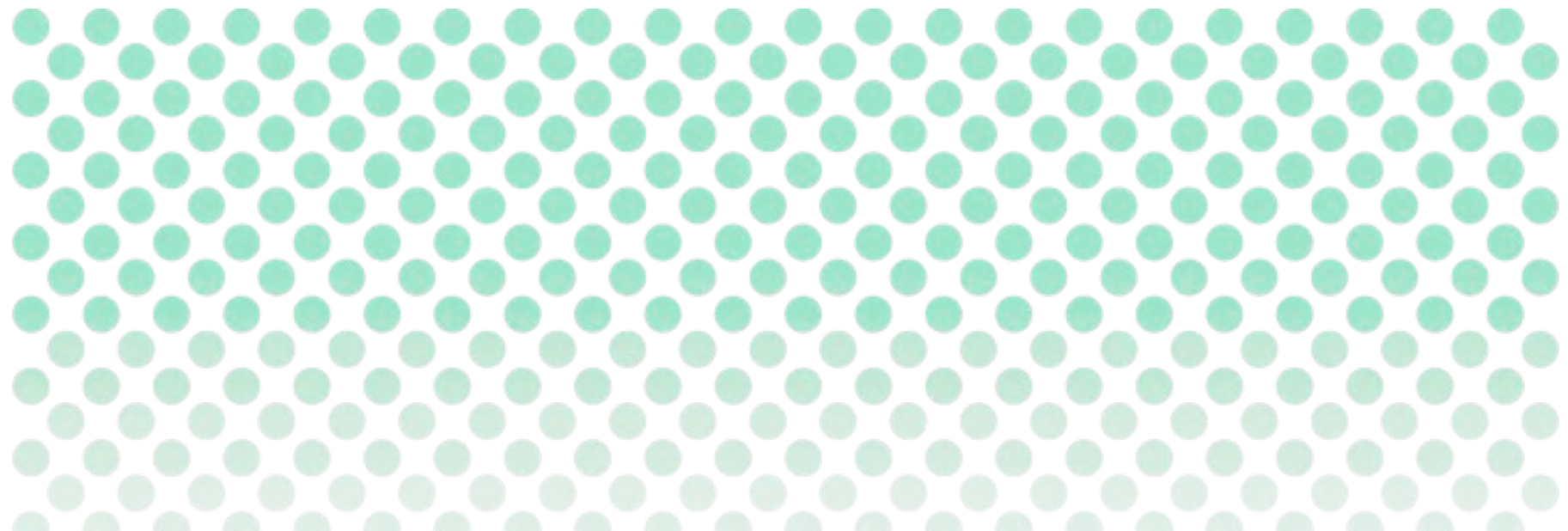

MONOGLASS SPRAYED THERMAL & ACOUSTIC INSULATION™



SAVES MONEY,
TIME & THE ENVIRONMENT

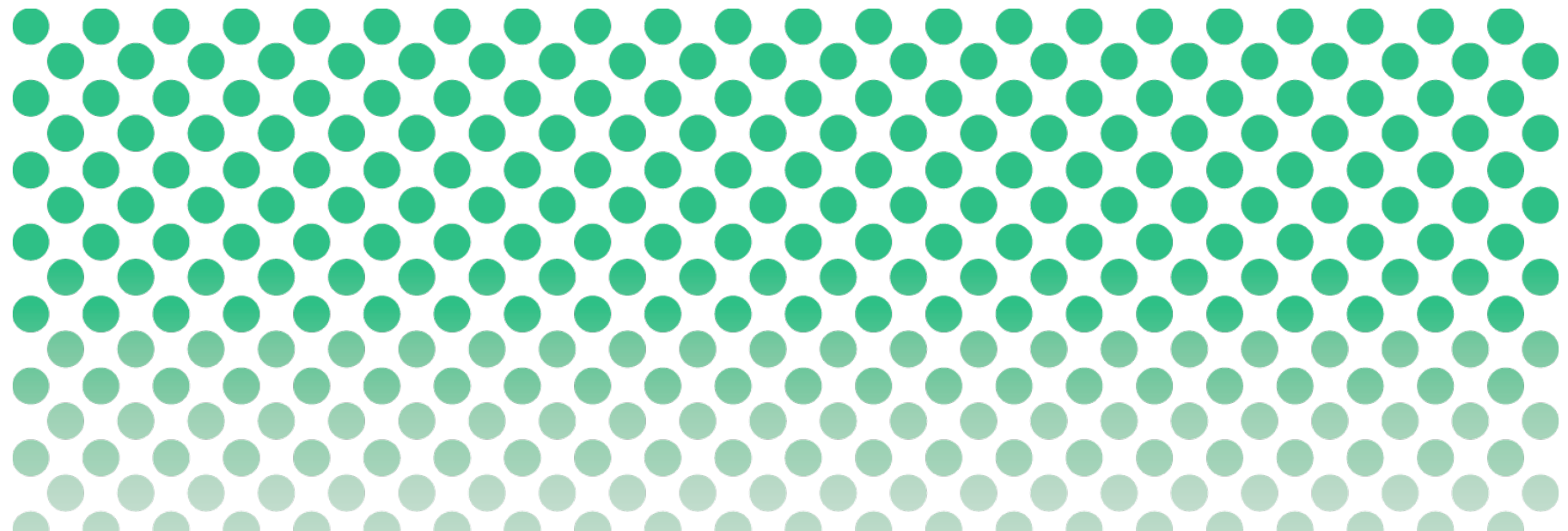

THERMAL & ACOUSTIC SINGLE SPRAY APPLICATION

SAVES



THERMAL & ACOUSTIC SINGLE SPRAY APPLICATION

MONOGLASS SPRAY-ON SYSTEM

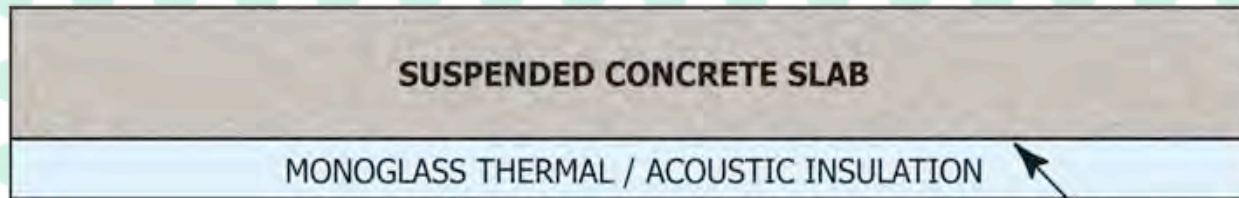

Cost Less ▶

SAVES



Minimal Thermal Leakage
= Energy Saved

TYPICAL BATT & BOARD SYSTEM

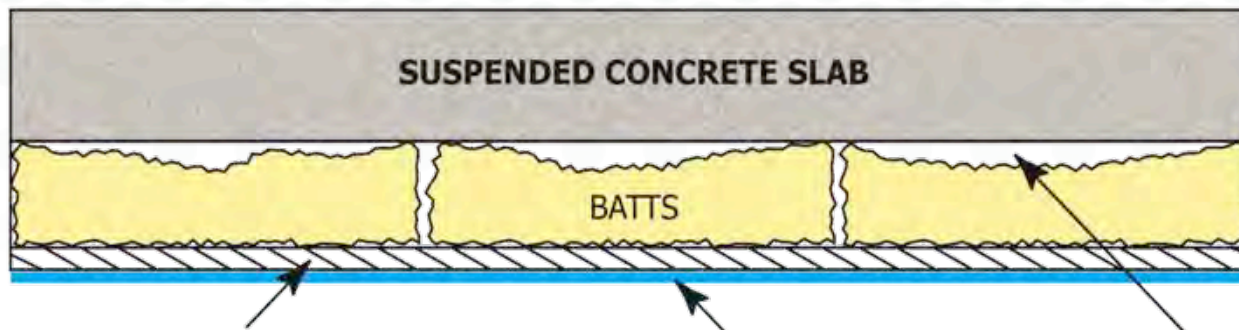

Cost More ▶

Thermal Leakage
= Energy Lost

THERMAL & ACOUSTIC SINGLE SPRAY APPLICATION

**UNDER FLOOR
SUSPENDED
CONCRETE SLABS**

SAVES



THERMAL & ACOUSTIC SINGLE SPRAY APPLICATION

**UNDER STEEL DECK
AROUND FORM WORK
SERVICES INSTALLED
AFTER INSULATION**

SAVES



THERMAL & ACOUSTIC SINGLE SPRAY APPLICATION

**CONCRETE
BAND BEAMS**

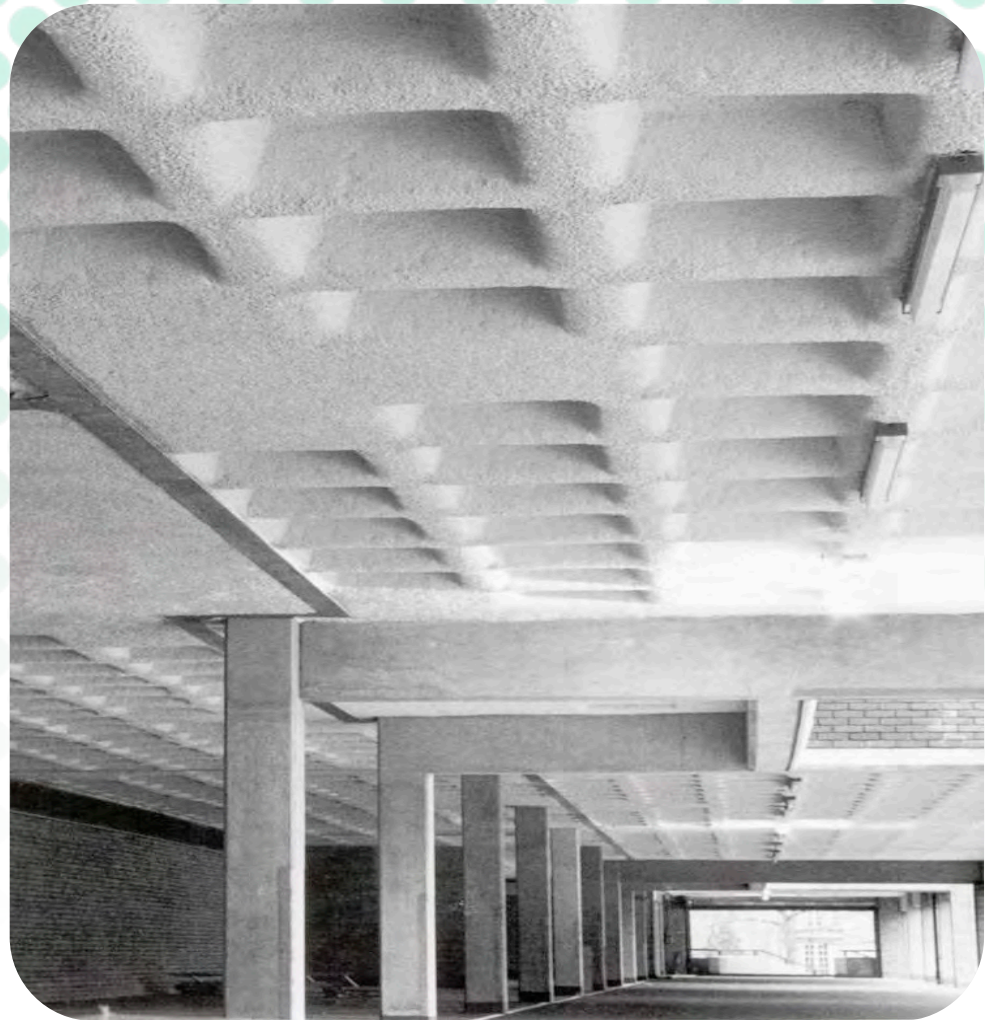

SAVES



THERMAL & ACOUSTIC SINGLE SPRAY APPLICATION

**TIMBER FLOORS
& VOIDS**



SAVES



THERMAL & ACOUSTIC SINGLE SPRAY APPLICATION

**MOST PAINTED
SURFACES**



SAVES





MONOGLASS SAVES MONEY

- :speed in application
- :single application
- :no thermal leakage
- :thinner profiling creates more height opportunity
- :thermal and acoustic 2 for 1
- :reduces building running cost



MONOGLASS SAVES TIME

- :faster installation
- :no mechanical fixing
- :can be installed last
- :retro fitted around services
- :25 year guarantee

MONOGLASS HELPS THE ENVIRONMENT



- :39% recycled content
- :zero VOC (volatile organic compounds)
- :zero flame, smoke and fuel
- :recycles again like steel (assisting product lifecycle)
- :no hazardous chemicals like Borate or Formaldehyde
- :reflective surface with less lighting requirement

PROJECT GALLERY

MELBOURNE CONVENTION CENTRE

BUILDER: BROOKFIELD MULTIPLEX
ARCHITECTS: WOODS BAGOT



SAVES



PROJECT GALLERY

SUNSHINE HOSPITAL

BUILDER: HOOKER COCKRAM

ARCHITECTS: HEALTH ARCHITECTURE



SAVES



PROJECT GALLERY

LIVING CARLTON

BUILDER: ST. HILLIERS

ARCHITECTS: JACKSON ARCHITECTURE



SAVES



PROJECT GALLERY

ANSTEY SQUARE

BUILDER: HICKORY

ARCHITECTS: URBAN DESIGN AND ASCUI EDWARDS



SAVES

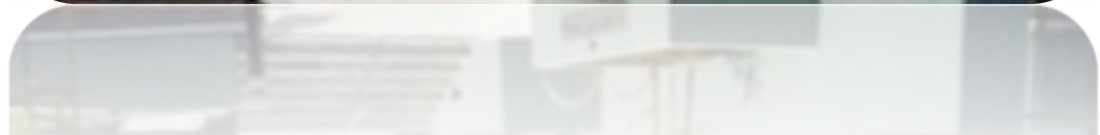

PROJECT GALLERY

CVU APARTMENTS

BUILDER: L.U. SIMON

ARCHITECTS: BRUCE HENDERSON ARCHITECTS



SAVES



PROJECT GALLERY

NEUROSCIENCE FACILITY PARKVILLE

BUILDER: BROOKFIELD MULTIPLEX
ARCHITECTS: LYONS

SAVES



PROJECT GALLERY

TAC GEELONG

BUILDER: HICKORY

ARCHITECTS: ML DESIGN + MGS ARCHITECTS



SAVES

